

Aluminum LED Strip

Series Type: A1418



Features 產品特點 >>

- PC cover : milky
- Size:14 mm (W) x 18.5 mm (H)
- SPM Design – power circuit protection to cut off individual LEDs when mal-functioned
- Aluminum to maximize heat dissipation
- Installation in serial for seamless lighting output
- Uniform light emission without LED spot
- Application: Kitchen cabinet, Bathroom cabinet ,Closet, Show cabinet, Retail shop,etc



- PC蓋:乳白色
- 尺寸: 14毫米(寬)X18.5毫米(高)
- 使用SPM設計-電源電路保護,在故障時切斷單個LED
- 採用鋁框架使散熱最大化
- 串聯安裝以實現無縫照明輸出
- 發光均勻,無LED光點
- 應用:廚櫃、浴室櫃、壁櫥、展示櫃、零售店等

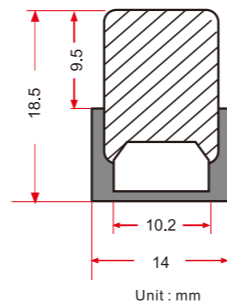

Specification 產品規格 >>

Model 型號	DC Voltage 電壓 (V)	Wattage 功率 (W)	Length 長度 (mm)	Lamp Life 光度壽命 (Hrs)	Colour Temp 色溫 (K)	Lumen Output 輸出流明 (Lm/W)	Color Rendering 顯色度 (CRI)	Beam Angle 光速角度 (°)	Operating Temperature 工作溫度 (°C)
CBL-A1418-S1004-109A	12/24	4	1000	50000	2700/3000/4000/6500	100	>90	180	-20~+45
CBL-A1418-S1008-109A	12/24	8	1000	50000	2700/3000/4000/6500	100	>90	180	-20~+45
CBL-A1418-S1205-109A	12/24	5	1200	50000	2700/3000/4000/6500	100	>90	180	-20~+45
CBL-A1418-S1210-109A	12/24	10	1200	50000	2700/3000/4000/6500	100	>90	180	-20~+45

- Light efficiency (lm/W),Power (W),Color Rendering Index (CRI), Length Can be customized according to customer needs
- Our Standard Power factor (PF) > 0.9 and Total harmonic index THD < 15%, According to customer requirements can produce a lower THD< 10%
- This type of certification is issued by a government-approved laboratory for Safety certification, Fire testing, Restriction of Hazardous Substances(RoHS), Photobiological safety of lamps and lamp systems.(an Exemption Group) and other test certifications to ensure product quality

- 光效 (lm/W)、功率 (W)、顯色指數 (CRI)、長度,可根據客戶需求定制
- 此型號標準之功率因素 (PF)>0.9,總諧波指數THD<15%,可按客戶需要生產低總諧波指數<10%
- 此型號認證由可實驗室發出之安全認證消防測試,環保物料 (RoHS),光生物安全為Exemption Group及其它測試,保證客戶使用更安心滿意

Aluminum LED Strip

Series Type: A1713



Features 產品特點 >>

- PC cover : milky
- Size: 17mm (W) x 13mm (H)
- SPM Design – power circuit protection to cut off individual LEDs when mal-functioned
- Aluminum to maximize heat dissipation
- Installation in serial for seamless lighting output
- Uniform light emission without LED spot
- Application: Kitchen cabinet, Bathroom cabinet ,Closet, Show cabinet, Retail shop,etc



- PC蓋:乳白色或透明
- 尺寸: 17毫米(寬)X13毫米(高)
- 使用SPM設計-電源電路保護,在故障時切斷單個LED
- 採用鋁框架使散熱最大化
- 串聯安裝以實現無縫照明輸出
- 發光均勻,無LED光點
- 應用:廚櫃、浴室櫃、壁櫥、展示櫃、零售店等

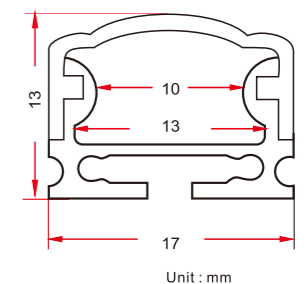

Specification 產品規格 >>

Model 型號	DC Voltage 電壓 (V)	Wattage 功率 (W)	Length 長度 (mm)	Lamp Life 光度壽命 (Hrs)	Colour Temp 色溫 (K)	Lumen Output 輸出流明 (Lm/W)	Color Rendering 顯色度 (CRI)	Beam Angle 光速角度 (°)	Operating Temperature 工作溫度 (°C)
CBL-A1713-S1004-108A	12/24	4	1000	50000	2700/3000/4000/6500	100	>90	120	-20~+45
CBL-A1713-S1008-109A	12/24	8	1000	50000	2700/3000/4000/6500	100	>90	120	-20~+45
CBL-A1713-S1205-109A	12/24	5	1200	50000	2700/3000/4000/6500	100	>90	120	-20~+45
CBL-A1713-S1210-109A	12/24	10	1200	50000	2700/3000/4000/6500	100	>90	120	-20~+45

- Light efficiency (lm/W),Power (W),Color Rendering Index (CRI), Length Can be customized according to customer needs
- Our Standard Power factor (PF) > 0.9 and Total harmonic index THD < 15%, According to customer requirements can produce a lower THD< 10%
- This type of certification is issued by a government-approved laboratory for Safety certification, Fire testing, Restriction of Hazardous Substances(RoHS), Photobiological safety of lamps and lamp systems.(an Exemption Group) and other test certifications to ensure product quality

- 光效 (lm/W)、功率 (W)、顯色指數 (CRI)、長度,可根據客戶需求定制
- 此型號標準之功率因素 (PF)>0.9,總諧波指數THD<15%,可按客戶需要生產低總諧波指數<10%
- 此型號認證由可實驗室發出之安全認證消防測試,環保物料 (RoHS),光生物安全為Exemption Group及其它測試,保證客戶使用更安心滿意